

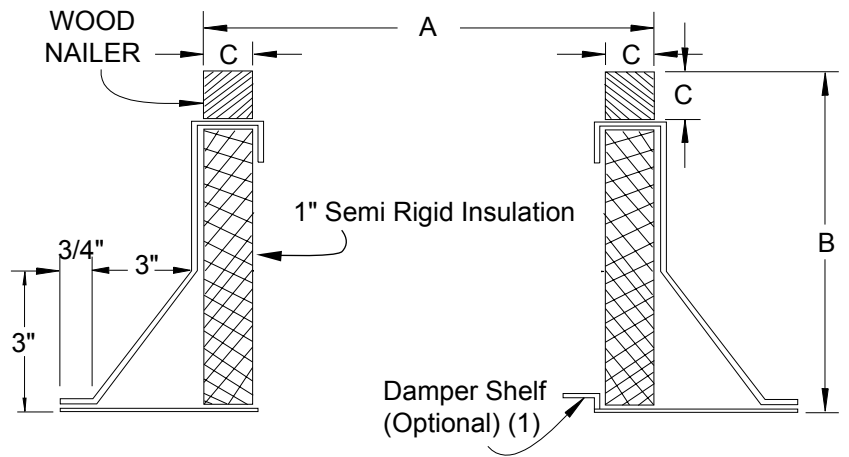

P: 866.733.0233  
www.solerpalaucanada.com

# INSULATED CANTED ROOF CURB FOR GRAVITY HOODS



"B" Curb Height - 12" STD

"C" Wood Nailer - 1 1/2" Sq

### OPTIONS

1. Damper Shelf
2. Insulation retainers - solid or screen type
3. Burglar Bars - 1/2" diameter on 6" centers.
4. Finishes - baked or air-dried enamel or epoxy.
5. Heights: 8, 12, 16, 18, 20, 24" or special heights.
6. Single pitch or double pitch.
7. Aluminum construction.
8. Standard curb is "RF" roof over type. ("SF" available upon request)

| Fan Size | Dimensions (in.) |                       |                       |
|----------|------------------|-----------------------|-----------------------|
|          | RCXII Spun       | RLX Louvered          | Gravity Hoods BGH/AGH |
| 4        | -                | Curb Cap minus 1 1/2" | Throat Size plus 7"   |
| 6        | 14 3/4           |                       |                       |
| 8        | 14 3/4           |                       |                       |
| 10       | 22 1/4           |                       |                       |
| 12       | 22 1/4           |                       |                       |
| 14       | 22 1/4           |                       |                       |
| 15       | -                |                       |                       |
| 16       | 22 1/4           |                       |                       |
| 18       | 27 3/4           |                       |                       |
| 20       | 27 3/4           |                       |                       |
| 24       | 33 3/4           |                       |                       |
| 26       | 33 3/4           |                       |                       |
| 30       | 40 3/4           |                       |                       |
| 33       | 40 3/4           |                       |                       |
| 36       | 40 3/4           |                       |                       |
| 42       | -                |                       |                       |
| 48       | -                |                       |                       |

1. Damper shelf opening to be 1" less than damper size. Shelf must be specified if required.
2. All curbs are 18 gauge G-90 galvanized steel with continuous seams.
3. Curb extensions - add 1" to "A" dimension.

### ROOF OPENING

Curb O.D. (A Dimension)  
Less 3.25 inches

| ACCESSORY ITEMS          | 1 | 2 | 3 | 4 | 5 | ACCESSORY ITEMS          | 1 | 2 | 3 | 4 | 5 |
|--------------------------|---|---|---|---|---|--------------------------|---|---|---|---|---|
| <input type="checkbox"/> |   |   |   |   |   | <input type="checkbox"/> |   |   |   |   |   |
| <input type="checkbox"/> |   |   |   |   |   | <input type="checkbox"/> |   |   |   |   |   |
| <input type="checkbox"/> |   |   |   |   |   | <input type="checkbox"/> |   |   |   |   |   |
| <input type="checkbox"/> |   |   |   |   |   | <input type="checkbox"/> |   |   |   |   |   |
| <input type="checkbox"/> |   |   |   |   |   | <input type="checkbox"/> |   |   |   |   |   |



P: 866.733.0233  
www.solerpalaucanada.com

# INSULATED CANTED ROOF CURB NON-PROPELLER PRODUCTS

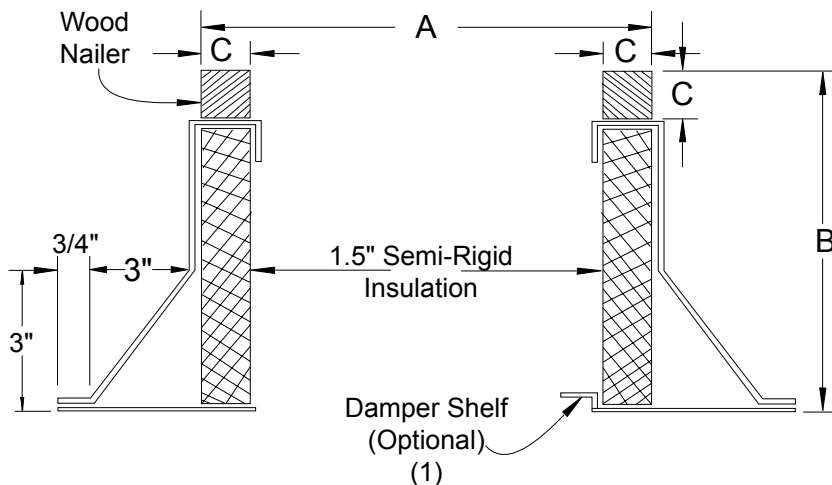

**OPTIONS:**

1. Damper Shelf.
2. Metal Liner - solid or screen type.
3. Burglar bars - 1/2" dia. on 6" centers.
4. Finishes - baked or air-dried enamel or epoxy.
5. Heights: 8, 12, 16, 18, 20, 24" or special heights.
6. Single pitch or double pitch.
7. Aluminum construction.
8. Standard curb is "RF" roof over type.  
("SF" available upon request)

| FAN SIZE | "A" OD (Square) CURB |        |        |           | DB       |             | "B" CURB HEIGHT | "C" WOOD NAILER |
|----------|----------------------|--------|--------|-----------|----------|-------------|-----------------|-----------------|
|          | TXB                  | TXD    | RCXII  | RED / LPD | FAN SIZE | CURB OD "A" |                 |                 |
| 6        | -                    | 14-3/4 | 14-3/4 | 14-3/4    | 6        | 14-3/4      | 12" STD         | 1-1/2" Sq       |
| 8        | 14-3/4               | 14-3/4 | 14-3/4 | 14-3/4    | 8        | 14-3/4      |                 |                 |
| 10       | 14-3/4               | 14-3/4 | 22-1/4 | 14-3/4    | 9        | 14-3/4      |                 |                 |
| 12       | 22-1/4               | 22-1/4 | 22-1/4 | 22-1/4    | 11       | 22-1/4      |                 |                 |
| 14       |                      |        | 22-1/4 |           |          |             |                 |                 |
| 15       | 22-1/4               | 22-1/4 | -      | 22-1/4    | 12       | 22-1/4      |                 |                 |
| 16       |                      |        | 22-1/4 |           |          |             |                 |                 |
| 18       | 27-3/4               | -      | 27-3/4 | -         | 14       | 22-1/4      |                 |                 |
| 20       | -                    | -      | 27-3/4 | -         | 16       | 22-1/4      |                 |                 |
| 24       | 33-3/4               | -      | 33-3/4 | -         | 18       | 27-3/4      |                 |                 |
| 26       | -                    | -      | 33-3/4 | -         | 20       | 27-3/4      |                 |                 |
| 30       | 40-3/4               | -      | 40-3/4 | -         | 24       | 33-3/4      |                 |                 |
| 33       | -                    | -      | 40-3/4 | -         | 30       | 40-3/4      |                 |                 |
| 36       | 40-3/4               | -      | 40-3/4 | -         | 36       | 40-3/4      |                 |                 |
| 42       | 53-1/4               | -      | -      | -         | 42       | 53-1/4      |                 |                 |
| 48       | 53-1/4               | -      | -      | -         | 48       | 53-1/4      |                 |                 |

1. Damper shelf opening to be 1" less than damper size. Shelf must be specified if required.
2. All curbs are 18 gauge G-90 galvanized steel with continuous seams.
3. See current curb submittal for all propeller fan roof curbs.

**ROOF OPENING**  
Curb O.D. (A Dimension) Less 3.25 inches

| ACCESSORY ITEMS          | 1 | 2 | 3 | 4 | 5 | ACCESSORY ITEMS          | 1 | 2 | 3 | 4 | 5 |
|--------------------------|---|---|---|---|---|--------------------------|---|---|---|---|---|
| <input type="checkbox"/> |   |   |   |   |   | <input type="checkbox"/> |   |   |   |   |   |
| <input type="checkbox"/> |   |   |   |   |   | <input type="checkbox"/> |   |   |   |   |   |
| <input type="checkbox"/> |   |   |   |   |   | <input type="checkbox"/> |   |   |   |   |   |
| <input type="checkbox"/> |   |   |   |   |   | <input type="checkbox"/> |   |   |   |   |   |

Project: \_\_\_\_\_ Submitted: \_\_\_\_\_  
 Customer: \_\_\_\_\_ Approved: \_\_\_\_\_  
 Location: \_\_\_\_\_



P: 866.733.0233  
www.solerpalaucanada.com

# BACKDRAFT DAMPERS FOR ROOF MOUNTED SUPPLY FANS

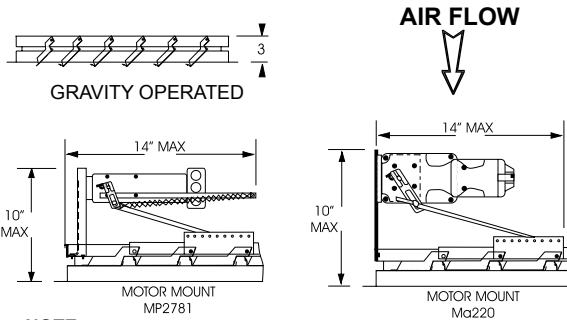

**NOTE**  
Counter balance weight kits are required on all supply dampers (gravity or motor operated).

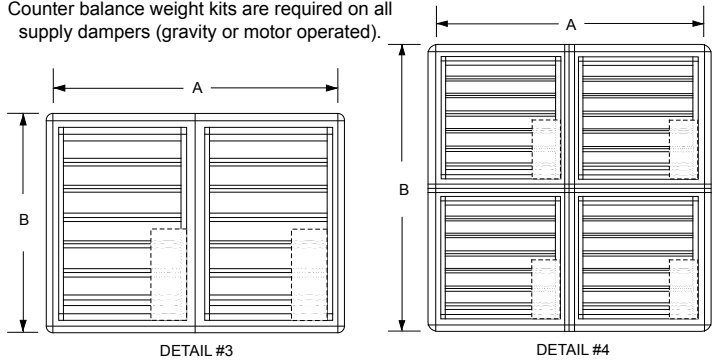

## PLAN VIEW (TOP)

### STANDARD SPECIFICATIONS:

- Maximum Face Velocity: 3000 fpm.
- Temperature limits: -40°F to 200°F (-40°C to 94°C)
- Minimum Size: 8 x 8
- Size: Single section: 42 x 64 Max W/H  
Multiple section assembly - Unlimited size.
- Frame: 20 gauge galvanized steel.
- Blades: .025 thick aluminum.  
HD 28 gauge galvanized steel.

Seals: Extruded vinyl mechanically locked into blades.

Axles: Stainless Steel.

Linkage: Stainless steel pins, galvanized steel tie bar.

Finish: Mill.

### NOTES:

- (1) Do not mount fan less than 12 inches from the shutter.
- (2) Motors available in 24V, 120V, 240V & 440V.
- (3) Dampers shipped in individual cartons.
- (4) Motors and spring kits ship separately.
- (5) Center-pivoted dampers must be used on reversible fans.
- (6) Multiple section assemblies may require bracing support the weight of the assembly and to hold against system pressure. **BRACING SUPPLIED BY OTHERS.**
- (7) Multiple section dampers are factory joined (except 72" and larger).

**CAUTION:** Motor kits are not suitable for use in explosive or flammable areas or airflows.

| FAN SIZE | CENTRIFUGAL ROOF FANS |                |           |                | PROP ROOF FANS           |                | ARS A Sq | MOTOR TYPE |     | PANELS (DETAIL) |
|----------|-----------------------|----------------|-----------|----------------|--------------------------|----------------|----------|------------|-----|-----------------|
|          | LSF, CSF & KSF        |                | RCXII     |                | HRSB, HRSBF, HRSD, HRSDF |                |          | TYPE       | QTY |                 |
|          | A Sq SIZE             | B Sq OD FLANGE | A Sq SIZE | B Sq OD FLANGE | A Sq SIZE                | B Sq OD FLANGE |          |            |     |                 |
| 6 or 8   | -                     | -              | 8         | 10-1/2         | -                        | -              | -        | MP2781     | 1   | 1               |
| 9        | 16                    | 18-1/2         | -         | -              | -                        | -              | -        | MP2781     | 1   | 1               |
| 10       | 20                    | 22-1/2         | 8         | 10-1/2         | -                        | -              | 14       | MP2781     | 1   | 1               |
| 12       | 20                    | 22-1/2         | 15        | 17-1/2         | -                        | -              | 18       | MP2781     | 1   | 1               |
| 15       | 24                    | 26-1/2         | 15        | 17-1/2         | -                        | -              | -        | MP2781     | 1   | 1               |
| 16       | -                     | -              | -         | -              | -                        | -              | 22       | MP2781     | 1   | 1               |
| 18       | 27                    | 29-1/2         | 21        | 23-1/2         | -                        | -              | -        | MP2781     | 1   | 1               |
| 20       | 42                    | 44-1/2         | 21        | 23-1/2         | -                        | -              | 26       | MP2781     | 1   | 1               |
| 24/26    | -                     | -              | 27        | 29-1/2         | 26                       | 28-1/2         | -        | MP2781     | 1   | 1               |
| 30/33    | -                     | -              | 34        | 36-1/2         | 32                       | 34-1/2         | -        | MP2781     | 1   | 1               |
| 36       | -                     | -              | 34        | 36-1/2         | 38                       | 40-1/2         | -        | MP2781     | 1   | 1               |
| 42       | -                     | -              | -         | -              | 44                       | 46-1/2         | -        | MA220      | 1   | 2               |
| 48       | -                     | -              | -         | -              | 50                       | 52-1/2         | -        | MA220      | 1   | 2               |
| 54       | -                     | -              | -         | -              | 56                       | 58-1/2         | -        | MA220      | 1   | 2               |
| 60       | -                     | -              | -         | -              | 62                       | 65-1/2         | -        | MA220      | 1   | 2               |
| 72       | -                     | -              | -         | -              | 76                       | 78-1/2         | -        | MP2781     | 4   | 4               |

Heavy Duty Dampers required on all units with 7 1/2HP motors and above.

| ACCESSORY ITEMS          | 1 | 2 | 3 | 4 | 5 | ACCESSORY ITEMS          | 1 | 2 | 3 | 4 | 5 |
|--------------------------|---|---|---|---|---|--------------------------|---|---|---|---|---|
| <input type="checkbox"/> |   |   |   |   |   | <input type="checkbox"/> |   |   |   |   |   |
| <input type="checkbox"/> |   |   |   |   |   | <input type="checkbox"/> |   |   |   |   |   |
| <input type="checkbox"/> |   |   |   |   |   | <input type="checkbox"/> |   |   |   |   |   |
| <input type="checkbox"/> |   |   |   |   |   | <input type="checkbox"/> |   |   |   |   |   |

Project: \_\_\_\_\_ Submitted: \_\_\_\_\_  
 Customer: \_\_\_\_\_ Approved: \_\_\_\_\_  
 Location: \_\_\_\_\_